



AMERICAN HIGH VOLTAGE
POWER SUPPLIES FOR THE WORLD

ZC Series Micro High Voltage Power Supply

General Description

The ZC Series high voltage power supplies provide isolated outputs. The output voltage of the ZC power supplies is directly proportional to the input voltage. Either output may be grounded to generate positive or negative output. ZC series are designed with unique filtering techniques and thus offer very low ripple and noise. The units are fully encapsulated in Diallyl Phthalate Case and come with metal EMI shield option. Other output voltages are available upon request.

Electrical Characteristic							
Model	Input Voltage (VDC)		Output Voltage (VDC)	Output Current (mA)	Ripple (mVp_p)	Input Current (mA)	
	Min	Max				No Load	Full Load
ZC-5	2	12	0 to 500	3	500 Max	100	300
ZC-12	2	12	0 to 1200	1.25	600 Max	100	300
ZC-15	2	12	0 to 1500	1	750 Max	100	300
ZC-20	2	12	0 to 2000	0.75	1000 Max	100	300

No-Load output voltage is typically 15% higher than Full-Load output voltage.

Environmental		
Characteristic	Minimum (°C)	Maximum (°C)
Operating Temperature (case)	-10	+60
Storage Temperature	-20	+90

Output Voltage is load dependent.

Under light or no-load conditions, reduce the input voltage so maximum rated output voltage is not exceeded.

Specifications after 30 minute warm-up, full load, at 25°C.

Customer is responsible to maintain the safe case temperature of the units.



AMERICAN HIGH VOLTAGE
POWER SUPPLIES FOR THE WORLD

Mechanical Outline

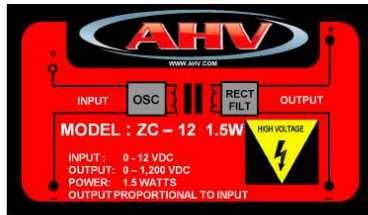
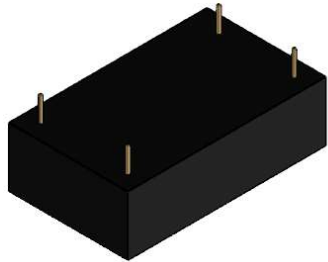
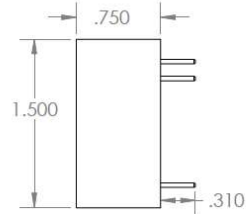
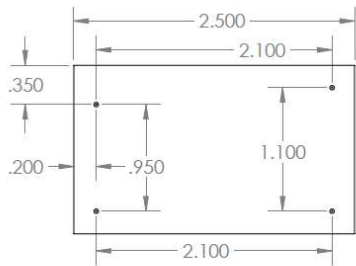

Dimensions are in Inches
Dimensional Tolerances .xx = ± .02, .xxx = ± .005

EMI Shield (Optional)

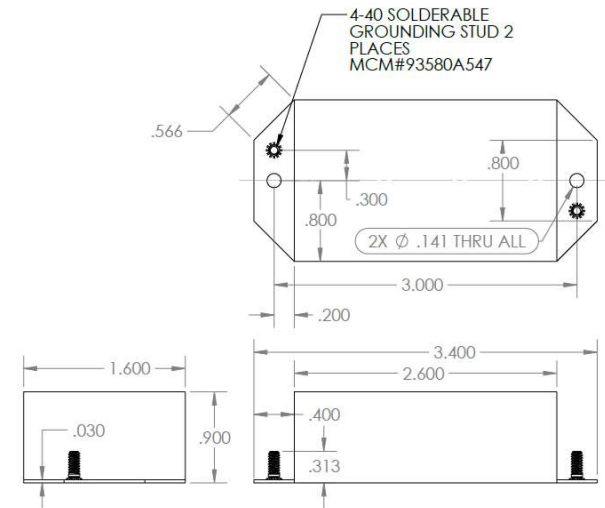
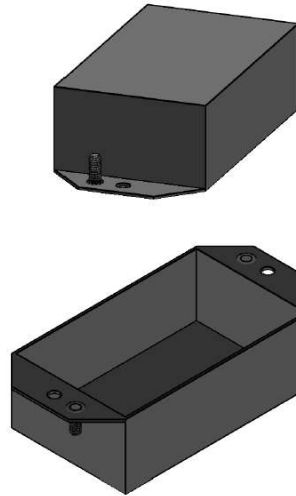

Dimensions are in Inches
Dimensional Tolerances .xx = ± .02, .xxx = ± .005